

PROPOSED FLOOR PLAN PROGRAM LAYOUT Ver. 2

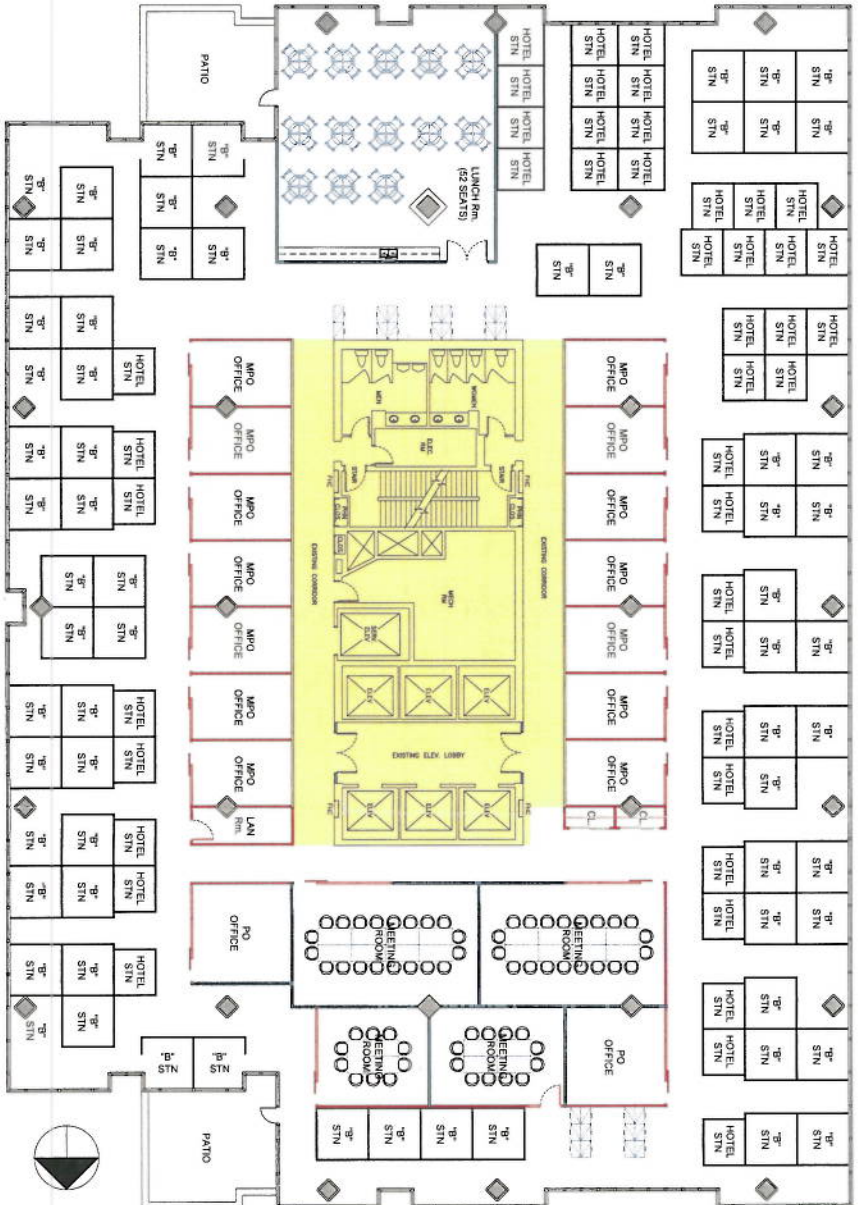

AREAS TO REMAIN.

SHOWING REQUIRED

- PO Office: 2/2
- MPO Office: 14/14
- "B" Station: 65/65
- "HOTEL" Station: 43/43
- MTG Rooms: 4/4
- TOTAL STAFF: 124

DENOTES NEW GYP. BRD. PARTITIONS

DENOTES NEW WALL SYSTEM & FRONTS.

NOTES:
 1. TO BE USED FOR ALL INFORMATION AND ALL DISCREPANCIES OF ANY KIND TO BE REPORTED TO THE ARCHITECT IMMEDIATELY UPON DISCOVERY.
 2. ALL WORK SHALL BE IN ACCORDANCE WITH THE LATEST EDITIONS OF THE CANADIAN B.C. STANDARDS FOR BUILDING PRACTICE AND THE CANADIAN B.C. STANDARDS FOR BUILDING PRACTICE.
 3. ALL WORK SHALL BE IN ACCORDANCE WITH THE LATEST EDITIONS OF THE CANADIAN B.C. STANDARDS FOR BUILDING PRACTICE AND THE CANADIAN B.C. STANDARDS FOR BUILDING PRACTICE.
 4. ALL WORK SHALL BE IN ACCORDANCE WITH THE LATEST EDITIONS OF THE CANADIAN B.C. STANDARDS FOR BUILDING PRACTICE AND THE CANADIAN B.C. STANDARDS FOR BUILDING PRACTICE.
 5. ALL WORK SHALL BE IN ACCORDANCE WITH THE LATEST EDITIONS OF THE CANADIAN B.C. STANDARDS FOR BUILDING PRACTICE AND THE CANADIAN B.C. STANDARDS FOR BUILDING PRACTICE.

ADDRESS: ATRIA II-8th FLOOR, 2235 SHEPPARD AVE. EAST, TORONTO, ONT.

PROJECT NAME: [Redacted]

PROJECT NO: [Redacted]

REVISIONS: [Redacted]

1. DESIGN FOR CLIENT REVIEW AND DISCUSSION (08/25)

DATE: 11/20/14

SCALE: AS NOTED ON PLAN

SHEET NUMBER: A118 - 01

PACIFIC PLANNING 2020